



Tow-Trust Towbars

Important: Please read General Notes overleaf before fitting



Issue 2

TBM 914VK BMW 5 Series Touring Estate 1997 - 2004

Item	Qty	Description	Item	Qty	Description
A	1	Crossmember	G	1	Flip Up Socket Plate
B	2	Bumper Brackets	H	6	M12 x 50 Bolts, Nuts & S/P Washers
C	2	Side Arms	J	4	M10 Nuts & S/P Washers
D	2	Side Arm Cleats	K	4	M12 x 25 Bolts & S/P Washers
E	1	Detachable Housing	L	8	12 x 25 Flat Washers
F	4	19 x 18 Spacer Bushes	M	2	10 x 30 Flat Washers

1. Remove the boot floor covering and side panels.
2. Remove the rear bumper. Six fixings inside the boot along the rear panel and three fixings around each wheel arch.
3. Remove the bumper support struts (these are no longer required), retain original bolts.
4. Cut a section from the lower edge of the bumper SEE SKETCH. If required trim to suit.
5. Locate Item **C** inside each chassis member with spacer bushes fitted over captive bolts, place Item **D** inside the boot and up against the rear panel, loosely bolt into position Using Item **M** and Item **J**.
6. Using Item **H** loosely bolt Item **A** through the top set of holes, through the rear panel and onto each side arm (Item **C**).
7. Using Item **H** loosely bolt Item **B** to Item **A**.
8. Using Item **K** with Item **L** bolt Item **E** and Item **G** to Item **A**.
9. Fully tighten all nuts and bolts and ensure the Towbar is rigid and secure.
10. Refit the bumper using original bolts.

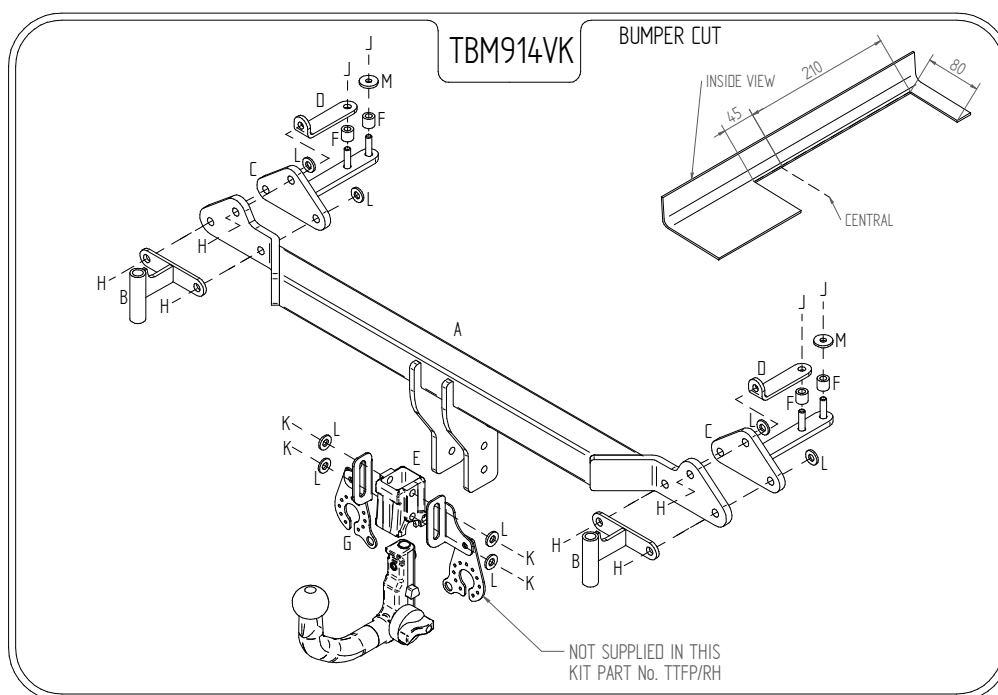

Note:

1. Recommended Torque Setting for M12 Grade 10.9 -139 Nm. (For other Torque Settings see notes overleaf.)
2. Nose load limits and vehicle manufacturers trailer / caravan weight limits must be observed.