



Tow-Trust Towbars

Important: Please read General Notes overleaf before fitting

Issue 8

TBM 915 BMW X5 (E70) '07> X6 (E71) '08>

Item	Qty	Description	Item	Qty	Description
A	1	Crossmember	D	2	M16 x 50 Bolts, Nuts & S/P Washers
B	1	Coupling Spacer	E	2	M12 x 100 Grade 10.9 Bolts & Nyloc Nuts
C	1	Extension bar	F	4	12 x 25 Flat Washers
			G	8	12 x 40 Flat Washers
			H	4	M12 Bolt Caps
			J	1	L/H Socket Plate
			K	6	Large Plastic Rivets
			L	1	M12 x 100 Grade 10.9 Bolt & Nyloc Nut
			M	2	6mm Spacer Plates

- X5:** Remove bottom skirt from bumper. All fixings along lower edge, all fixings around each wheel arch, one fixing behind each reflector.
X6: Remove complete rear bumper.
- Remove bumper beam and retain original fixings.
- X6:** Place item **A** in line with towbar mounting points and mark the plastic on the rear panel then trim the plastic so item **A** can bolt up flush.
- Using original fixings and Item **G** bolt Item **A** to the rear panel. **NOTE:** Some Vehicles require Item **M** Between the rear panel and the Towbar to give extra clearance along the top edge of Item **A** and the inner plastic bumper support.
- As a precaution seal around each end plate of the towbar to prevent water damage.
- Fully tighten all fixings and ensure the towbar is rigid and secure.
- Cut a section centrally from the lower edge of the bumper skirt **X5:** 75mm Wide x 65mm Deep.
X6: See Sketch.
- Refit bumper skirt.
- Using Item **E** with Item **F** and Item **L** with Item **F** bolt Item **C** and Item **J** to Item **A**.
- Fit bolt caps (Item **H**) onto Item **E**.
- Using Item **D** bolt the ball bracket (not supplied in this kit) and Item **B** (if required) to the mounting plate.

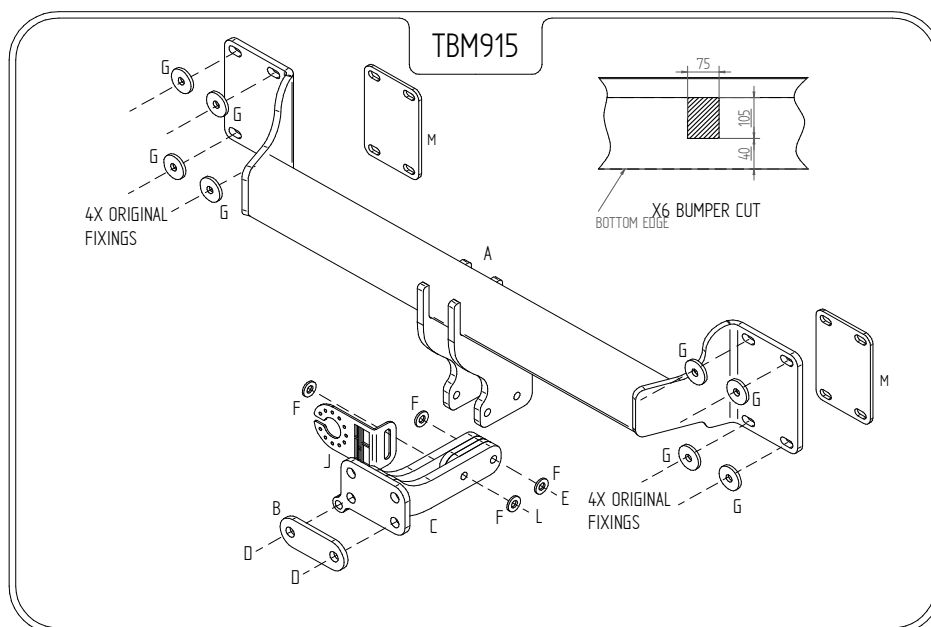

Note:

- Recommended Torque Setting for M12 Grade 10.9 -139 Nm. (For other Torque Settings see notes overleaf.)
- Nose load limits and vehicle manufacturers trailer / caravan weight limits must be observed.