



Tow-Trust Towbars

Important: Please read General Notes overleaf before fitting

Issue 1

TC711B Mitsubishi L200 Import Model 1996>

Item	Qty	Description	Item	Qty	Description
A	1	Crossmember	F	2	M16 x 50 Bolts, Nuts & S/P Washers
B	2	Side Arms	G	16	M12 x 40 Bolts, Nyloc Nuts
C	2	Handed Clamp Plates	H	4	M10 x 40 x 1.25 Bolts & S/P Washers
D	2	Angle Brackets	J	8	12 x 25 Flat Washers
E	1	Coupling Spacer	K	4	10 x 25 Flat Washers

1. Remove bumper from chassis brackets (two fixings each side).
2. Remove fixings either side securing chassis brackets to each chassis member.
3. Using Item **G** with Item **J** loosely bolt Item **B** to the existing holes in each chassis member. Use Item **C** with nyloc nuts provided (Item **G**) on forward holes. (See sketch.)
4. Using Item **G** loosely bolt Item **D** to Item **B** and to the existing hole in the bottom face of each chassis member.
5. Using Item **G** bolt Item **A** to Item **B**.
6. Using Item **F** with Item **E** (if required) bolt the ball bracket and wiring plate (not supplied in this kit) to the mounting plate.
7. Fully tighten all nuts and bolts and ensure the towbar is rigid and secure.
8. Using Item **H** with Item **K** bolt the original step to the inside face of the towbar side arms.

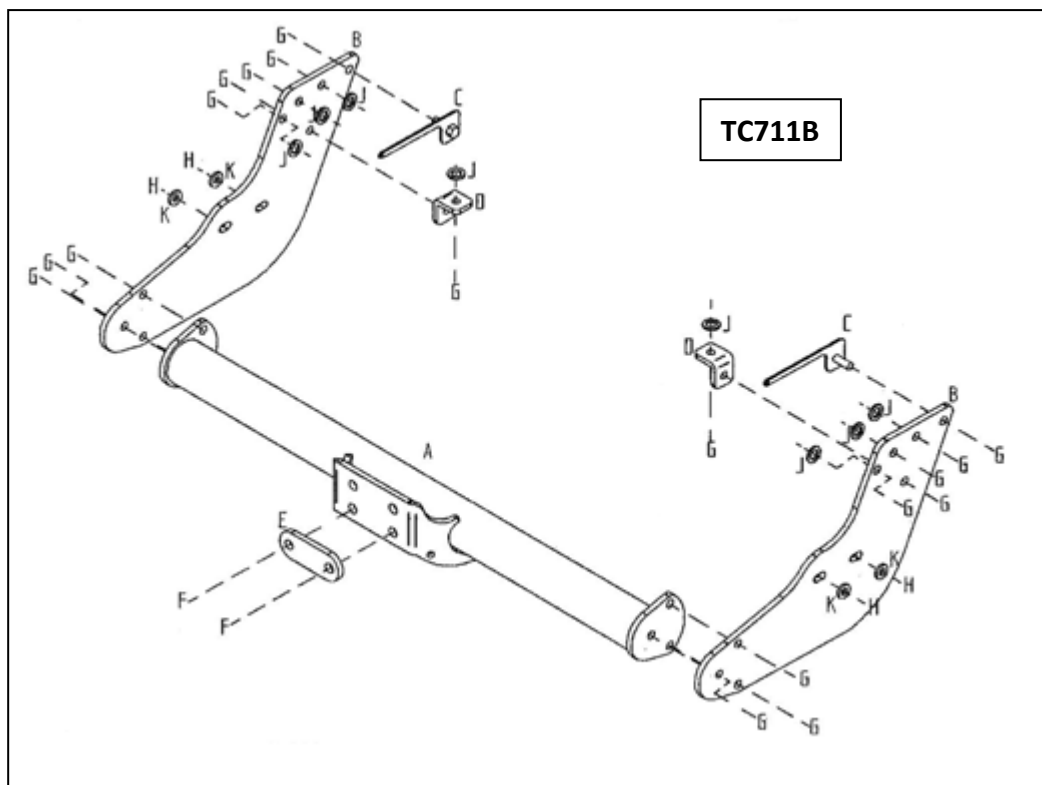

Note:

1. Recommended Torque Setting for M12 Grade 10.9 -139 Nm. (For other Torque Settings see notes overleaf.)
2. Nose load limits and vehicle manufacturer's trailer / caravan weight limits must be observed.