



Tow-Trust Towbars

Important: Please read General Notes overleaf before fitting

Issue 4

TM898 Mercedes A Class / B Class 2005>

Item	Qty	Description	Item	Qty	Description
A	1	Crossmember	E	2	M16 x 50 Bolts, Nuts & S/P Washers
B	1	L/H Side Arm	F	2	M12 x 90 Grade 10.9 Bolts & Nyloc Nuts
C	1	R/H Side Arm	G	6	M12 x 35 Bolts, 4 Nuts & 6 S/P Washers
D	1	Extension Bar	H	8	M10 x 35 Bolts & S/P Washers
			K	4	10 x 40 Flat Washers
			L	14	12 x 25 Flat Washers
			M	4	10 x 25 Flat Washers

IMPORTANT: IT IS ADVISABLE TO USE A SEALANT ON MATING FACES, AND AROUND ANY MOUNTING POINTS ON REAR PANEL TO PREVENT ANY WATER DAMAGE TO CHASSIS OR BOOT.

1. Remove rear bumper. Four fixings along bottom edge, four fixings behind the covers along top edge, one fixing each side securing wheel arch liners and one fixing each side behind wheel arch liners.
2. Remove bumper beam. (This is not refitted with the towbar.)
3. Remove the spare wheel.
4. Remove the boot carpet from sides and rear of the boot.
5. Remove the two rearmost rubber grommets from the inside face of each chassis member.
6. Locate Item **B** and Item **C** into each chassis and using Item **H** with Item **K** loosely bolt through the existing holes.
7. Using Item **H** with Item **M** and Item **G** with Item **L** loosely bolt Item **B** and Item **C** to the existing holes in the rear panel.
8. Using Item **G** and Item **L** bolt Item **A** to item **B** and Item **C**.
9. Fully tighten all nuts and bolts and ensure the towbar is rigid and secure.
10. Cut a section centrally from the lower edge of the bumper 60mm wide x 80mm deep. If required trim to suit.
11. Re-fit bumper
12. Using Item **F** with Item **L** bolt Item **D** to Item **A**.
13. Using Item **E** bolt the ball bracket and wiring plate (not supplied in this kit) to the mounting plate.
14. Re-fit spare wheel and boot carpet.

Note:

1. Recommended Torque Setting for M12 Grade 10.9 -139 Nm. (For other Torque Settings see notes overleaf.)
2. Nose load limits and vehicle manufacturers trailer / caravan weight limits must be observed.

TM898

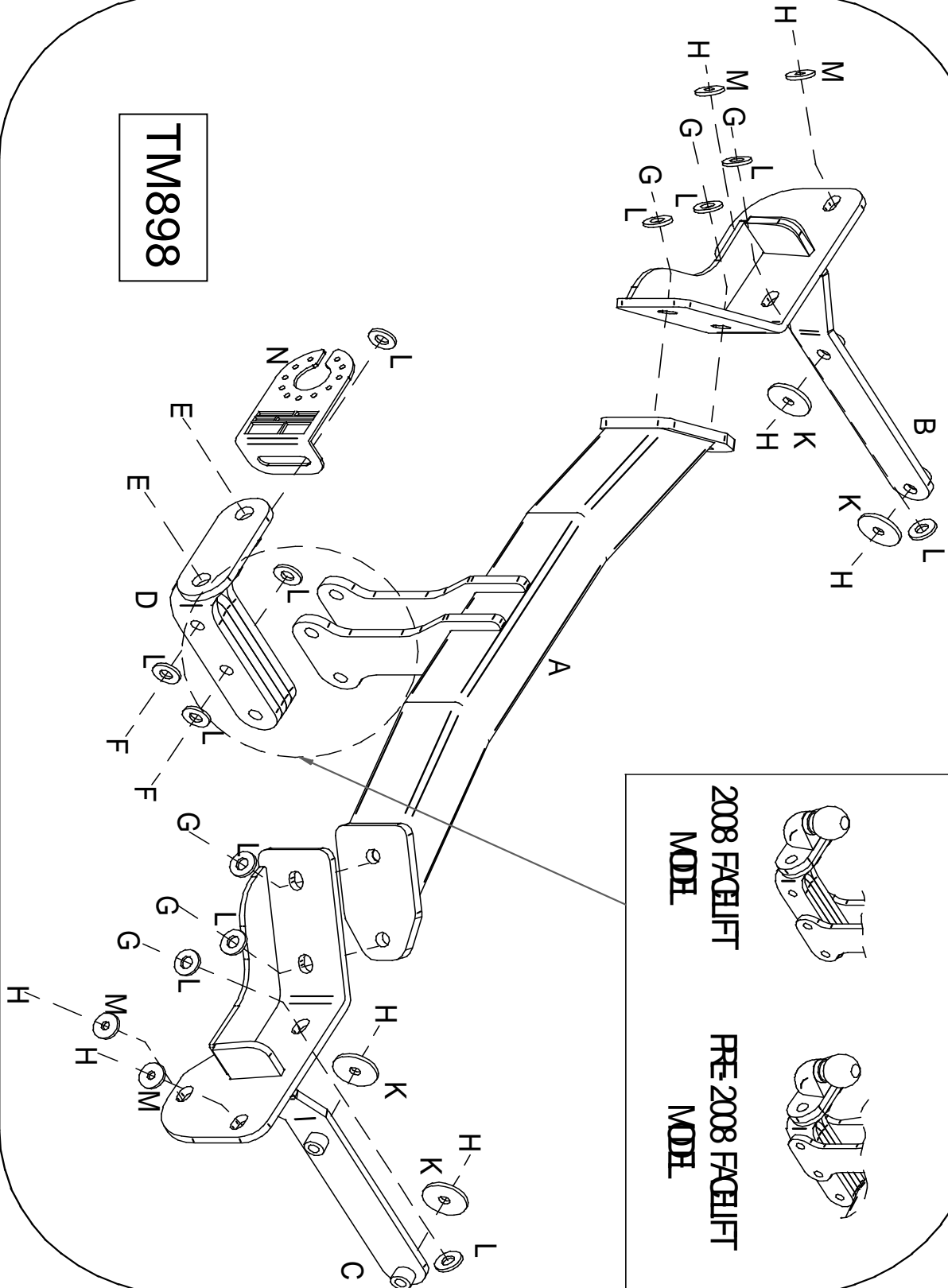

Tow with Trust