



Tow-Trust Towbars

Important: Please read General Notes overleaf before fitting

Issue 2

**TST2 SEAT IBIZA 2008> VOLKSWAGEN POLO 2009>
SEAT IBIZA ST 2010> AUDI A1 2010>**

Item	Qty	Description	Item	Qty	Description
A	1	Crossbar	E	2	M16 x 50 Bolts, Nuts & S/P Washers
B	1	Extension Bar	F	8	M10 x 40 Bolts 2 Nuts & 8 S/P Washers
C	2	Side Arms	G	2	M12 x 40 Bolts & S/P Washers
D	2	M10 Clamp Plates	H	1	M12 x 100 Bolt & Nyloc Nut
			J	6	10 x 30 Flat Washers
			K	4	12 x 25 Flat Washers

1. **SEAT IBIZA & SEAT IBIZA ST only:** Remove the rear light clusters.
2. Remove the rear bumper.
3. Remove the rear crash beam (This is not refitted with Towbar assembly).
4. Locate towbar mounting points on the outside face of each chassis member, these are usually covered in tape.
5. Insert items **C** into each chassis member, choose correct hole location for vehicle, line up with towbar mounting points in chassis members then loosely fix in place using item **F** and item **J** (**USING ITEM D ON FORWARD MOST MOUNTING POINT IF NEEDED**).
6. Using item **F** and item **J** bolt item **A** between items **C**.
7. Using item **G** with item **K** and item **H** with item **K** bolt item **B** to item **A**.
8. Using item **E** bolt your desired ball bracket and wiring plate (not supplied in this kit) to item **B**.
9. Cut the bumper to the correct sketch for your vehicle and refit.

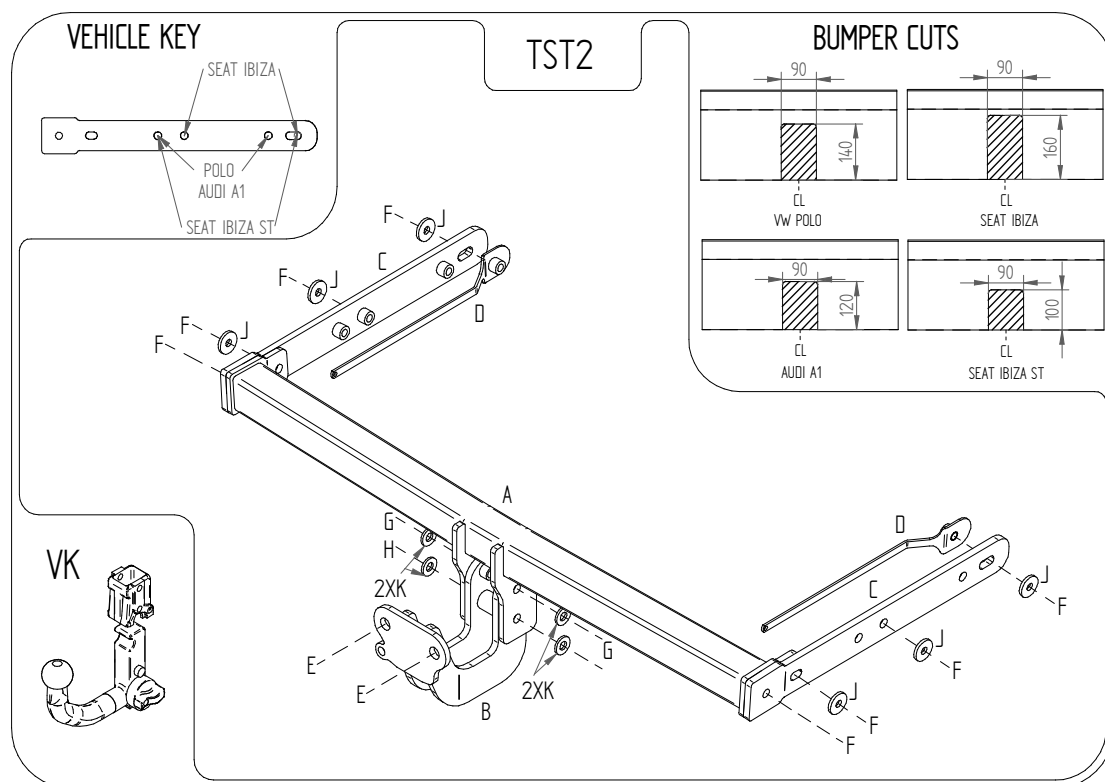

Note:

1. Recommended Torque Setting for M12 Grade 10.9 -139 Nm. (For other Torque Settings see notes overleaf.)
2. Nose load limits and vehicle manufacturer's trailer / caravan weight limits must be observed.